

## LED ceiling-recessed luminaire

Recessed LED downlight, one for one replacement for traditional 2x26W compact fluorescent downlights. Consistent light output with no shadowing. High efficacy, up to 80% energy saving compared with fluorescent light sources. 200mm cut-out – identical to traditional products. AMY LED can be installed into a wide range of ceiling types of 2-20mm thickness. THD<25%.

Body: Aluminium white finish (RAL 9003)

Diffuser: Polycarbonate (TPb construction)

Weight: 0.36 kg



TE\_AMY\_F\_200\_side.jpg

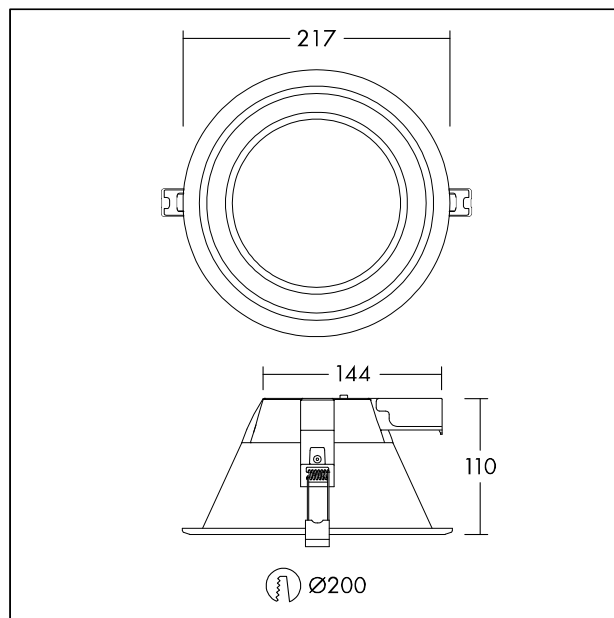

TE\_AMY\_M\_LGE.wmf

## Light Distribution

## STD - standard

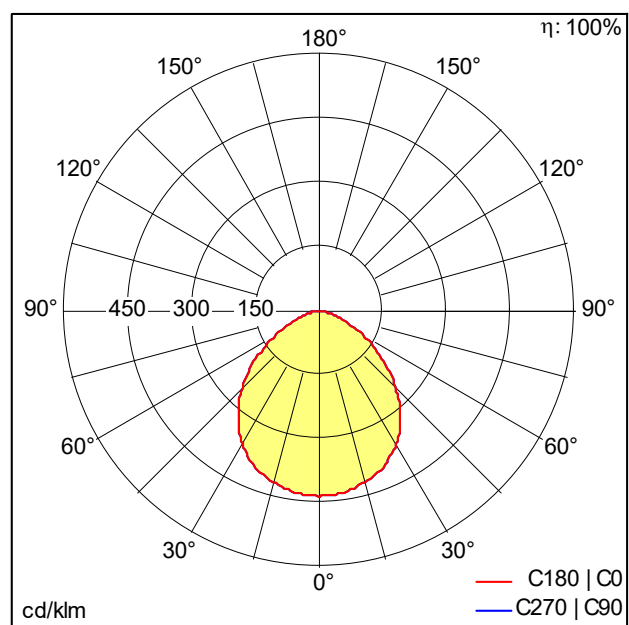

TE\_AMY\_200\_LED\_DL\_2000\_830.ltd

- Light Source: LED
- Luminaire luminous flux\*: 2002 lm
- Luminaire efficacy\*: 95 lm/W
- Colour Rendering Index min.: 80
- Correlated colour temperature\*: 3000 Kelvin
- Chromaticity tolerance (initial MacAdam): 4
- Rated median useful life\*:  
L70 50000 h at 25 °C
- Ballast: 1x LED\_Con
- Luminaire input power\*: 21 W Power factor = 0.9
- Dimming: Fixed output
- Maintenance category CIE 97: D - Enclosed IP2X

All values marked with an \* are rated values. Connected electrical load and luminous flux are subject to an initial tolerance of +/- 10%, the most similar colour temperature is subject to an initial tolerance of +/- 150K. Unless stated otherwise, the values apply to an ambient temperature of 25°C.