



### JUST E3 LINEAR P&P KIT SelfTest LiFePO4

<b>EN</b> Installation Instructions	<b>IT</b> Istruzioni di montaggio
<b>DE</b> Montageanleitung	<b>LT</b> Montavimo Instrukcijos
<b>CZ</b> Montážní návod	<b>LV</b> Instalācijas instrukcija
<b>DK</b> Monteringsvejledning	<b>NO</b> Monteringsanvisning
<b>EE</b> Paigaldusjuhend	<b>PL</b> Instrukcja montażu
<b>FI</b> Asennusohje	<b>SE</b> Installationsanvisning
<b>FR</b> Notice de montage	<b>RU</b> Инструкция по монтажу
<b>HU</b> Szerelési útmutató	<b>SRB</b> Instrukcija za instalaciju
<b>HR</b> Uputstvo za montažu	<b>SK</b> Montážny návod
<b>NL</b> Montagehandleiding	<b>SLO</b> Navodilo za montažo
<b>RO</b> Instructuni de montaj	<b>CN</b> 安装说明书



1. Installation and commissioning may only be carried out by authorized specialists and wired in accordance with the latest IEEE electrical regulations or the national standards.



2. The manufacturer shall not be liable for any damage resulting from inappropriate modifications to the luminaire or faulty installation.

3. Light source can't be replaced.  
The control gear provides basic insulation between the LV supply and the control circuit

SAP Code	Product Description	Input	Input Wattage	Operation temperature
96700027	JUST E3 LINEAR P&P KIT SelfTest LiFePO4	AC 220-240V 50/60Hz	3.5W max	0+25°C

#### Dimensions

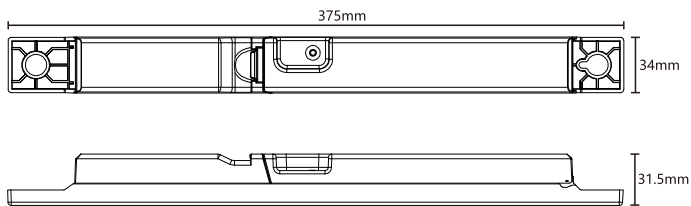

#### Wiring diagram(Non-maintained)

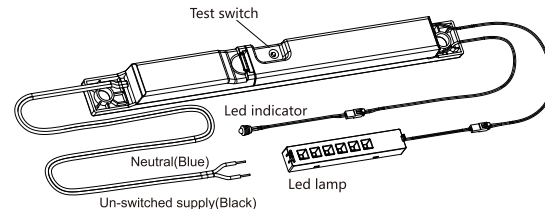

#### Compatible with:

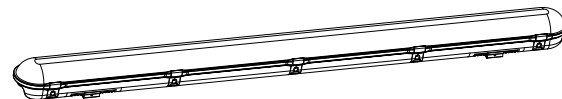

SAP Code	Product Description	UK Cat No
96700011	JULIE FLEX 1200 4200 840	JU4200F4F
96700013	JULIE FLEX 1200 4200 840 COR MWS	JU4200FCM4F
96700015	JULIE FLEX 1500 6300 840	JU6300F5F
96700017	JULIE FLEX 1500 6300 840 COR MWS	JU6300FCM5F
96700019	JULIE FLEX 1500 8600 840	JU8600F6F

1

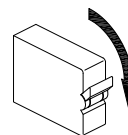

2

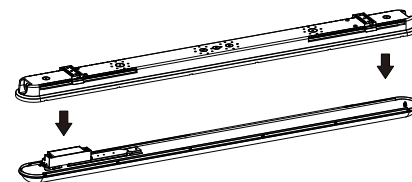

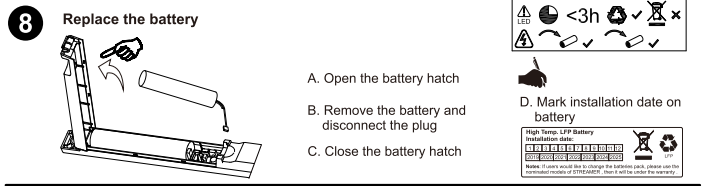
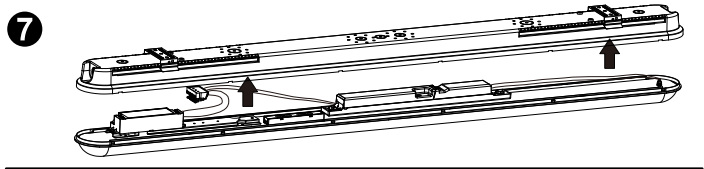
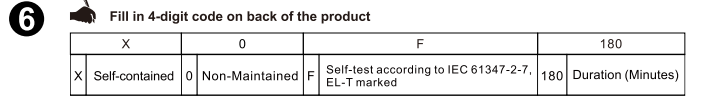
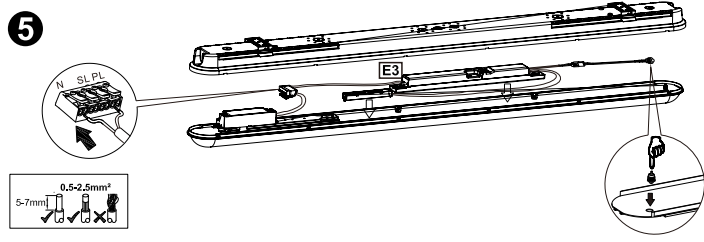
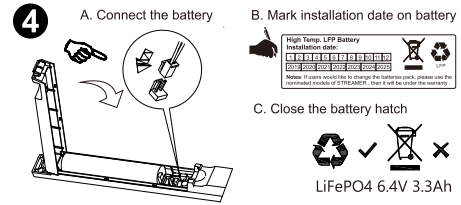
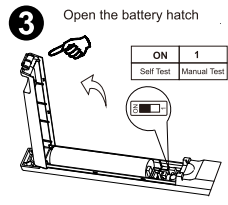

**Self-test**

The emergency kits carry out self-tests automatically to ensure its functionality. The self-test includes 3 types of tests:

**Initial test**

- As soon as mains supply is connected, the emergency kit will carry out a 3-seconds functional test automatically.
- In case of a failure, the LED will turn permanent red. Otherwise, the charge mode will start.

**Functional test**

- Refers to charging, discharging and the functioning of load.
- Carry out for 10 seconds automatically every 30 calendar days.

**Duration test**

- Refers to the test of batteries capacity.
- Carry out every 180 calendar days.

**Rest mode**

Rest mode can be initiated during emergency mode by pressing test switch longer than 3 seconds. The rest mode will be exited automatically after reconnect AC mains.

**Timer reset**

Press test switch >15 seconds in charging mode, will reset timer for functional and duration test. Meanwhile indicator red flash once, then indicator green slowly flash 3 times, this means timer resetting is successful.

**Please note**

If mains supply is off during self-test period, emergency conversion module would terminate self-test immediately and go into emergency mode.

Self-test is under the regulation of EN62034.

Yearly manual test will have no impact on battery life.

**Explanation of LED indicator**

	Color	LED indication	Status	Comment
	Green	Permanent green	Charging mode Fully charged	AC mode
	Green	Fast flashing green (0.1 sec on, 0.1 sec off)	Function test underway	
	Green	Slow flashing green (1 sec on, 1 sec off)	Duration test underway	
	Red	Permanent red	Load failure	Open circuit/ Short circuit Led failure (emergency mode)
	Red	Slow flashing red (1 sec on, 1 sec off)	Battery failure	Battery failed the duration test or function test / No battery
		Green and red off	DC mode	Battery operation (emergency mode)

